

# Saxon Indicators

A range of 2½", 3½" and 4½" surface mount panel meters utilising pivot and jewel mechanisms and offering IP54 protection. The range includes iron vane and moving coil AC and DC ammeters and voltmeters and frequency meters designed to perform in demanding environments.

## Specifications - Frequency Meters

|            |   |
|------------|---|
| Accuracy:  | 0.15 = 60Hz, 1.25 = 400Hz, 0.15 = 50Hz, 0.25 = 55Hz |
| Voltage:   | 110/130V, 200/250V                                  |
| Frequency: | 50Hz or 60Hz  |
| Burden:    | 4VA Maximum   |

## Specifications - Moving Iron AC Ammeter and Voltmeter

|           |   |
|-----------|---|
| Accuracy: | ±2%   |
| Rating:   | Ammeters: 1 - 30A<br>Voltmeters: 10V - 600V   |
| Overload: | Ammeters: x1.2 for 2 hours, x10 for 5 seconds<br>Voltmeters: x1.2 for 2 hours, x2 for 5 seconds |
| Burden:   | Ammeters: 0.5VA<br>Voltmeters: 4.5VA maximum  |

## Specifications - Moving Coil DC Ammeter and Voltmeter

|                        |   |
|------------------------|---|
| Accuracy:              | ±2%   |
| Rating:                | Ammeters: 1 - 30A<br>Voltmeters: 10V - 600V |
| Operating temperature: | -20°C to 60°C (-4°F to 140°F)               |
| Storage temperature:   | -30°C to 70°C (-22°F to 158°F)              |

## Dimensions

Specify number of fixing studs when ordering 2½" and 3½" meters. 4½" meters are supplied with 4 fixing studs.

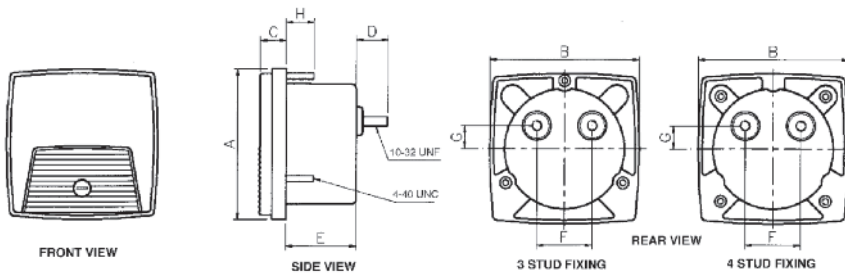

|      | A     | B     | C    | D    | E    | F    | G    | H    | J    | K    | L    | M    | N    | P    | Q    |
|------|-------|-------|------|------|------|------|------|------|------|------|------|------|------|------|------|
| 2½mm | 68.6  | 68.6  | 11.8 | 14.6 | 32.0 | 25.4 | 10.4 | 12.7 | 55.9 | 31.0 | 46.5 | 26.9 | 23.9 | 47.8 | 23.9 |
| inch | 2.70  | 2.70  | 0.46 | 0.57 | 1.26 | 1.00 | 0.41 | 0.50 | 2.20 | 1.22 | 1.83 | 1.06 | 0.94 | 1.88 | 0.94 |
| 3½mm | 88.9  | 88.9  | 11.8 | 14.6 | 36.0 | 25.4 | 10.4 | 12.7 | 69.9 | 40.2 | 60.3 | 34.8 | 28.5 | 57.0 | 28.5 |
| inch | 3.5   | 3.5   | 0.46 | 0.57 | 1.42 | 1.00 | 0.41 | 0.50 | 2.75 | 1.58 | 2.37 | 1.37 | 1.12 | 2.24 | 1.12 |
| 4½mm | 112.0 | 123.2 | 12.7 | 16.3 | 30.5 | 28.4 | 0.38 | 12.7 | 70.9 |      |      |      | 51.6 | 90.4 | 50.8 |
| inch | 4.41  | 4.85  | 0.50 | 0.64 | 1.20 | 1.12 | 0.41 | 0.50 | 2.78 |      |      |      | 2.03 | 3.56 | 2.00 |

## Panel cut-out

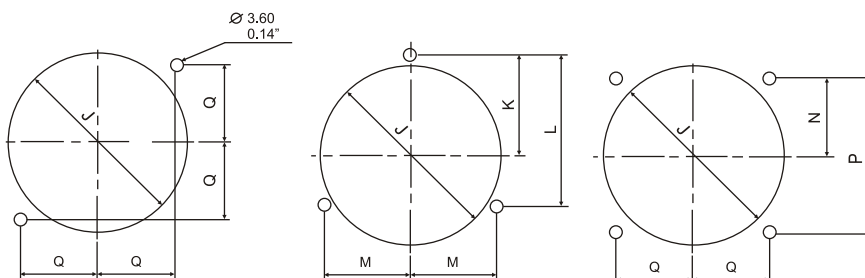

## Features

- Three compact case sizes
- Withstands high levels of shock, vibration, dirt and humidity
- Pivot and jewel mechanisms

## Benefits

- Complies with ANSI C39.1 (IEC 51)
- IP54 (NEMA 3) protection
- Instruments comply with BSEN61010-1 and meet IEC414 (BS5458)
- Pass dielectric test (2600V for 1min)

## Applications

- Switchgear
- Distribution systems
- Generator sets
- Control panels
- Energy management
- Building management
- Utility power monitoring
- Process control
- Motor control

## Compliant with

- UL approved file no. E203000

## Connections

See page 25



AC Ammeter

**Product Codes - AC Ammeter True RMS Reading (Accuracy ±2% ES)**

| Rating | Scaling           | Cat. no.              |
|--------|-------------------|-----------------------|
| 5A     | 0-5A              | (01*)-75AA-LSLS-C6-B* |
| 10A    | 0-10A             | (01*)-75AA-MTMT-C6-B* |
| 15A    | 0-15A             | (01*)-75AA-NDND-C6-B* |
| 20A    | 0-20A             | (01*)-75AA-NGNG-C6-B* |
| 30A    | 0-30A             | (01*)-75AA-NLNL-C6-B* |
| 1A     | Transformer rated | (01*)-75AA-LA**-C6-B* |
| 5A     | Transformer rated | (01*)-75AA-LS**-C6-B* |

**Product Codes - AC Voltmeter True RMS Reading (Accuracy ±2% ES)**

|      |                   |                       |
|------|-------------------|-----------------------|
| 150V | 0-150V            | (01*)-75VA-PZPZ-C6-B* |
| 300V | 0-300V            | (01*)-75VA-RXRX-C6-B* |
| 600V | 0-600V            | (01*)-75VA-SJSJ-C6-B* |
| 150V | Transformer rated | (01*)-75VA-PZ**-C6-B* |

**Product Codes - DC Ammeters (Accuracy ±2% ES)**

|          |                      |                    |
|----------|----------------------|--------------------|
| 0-1mA    | To suit requirements | (01*)-01AA-FA**-B* |
| 0-5mA    | 0-5mA                | (01*)-01AA-FXFX-B* |
| 0-10mA   | 0-10mA               | (01*)-01AA-GZGZ-B* |
| 0-20mA   | 0-20mA               | (01*)-01AA-HFHF-B* |
| 0-50mA   | 0-50mA               | (01*)-01AA-HYHY-B* |
| 0-100mA  | 0-100mA              | (01*)-01AA-JRJR-B* |
| 0-200mA  | 0-200mA              | (01*)-01AA-KAKA-B* |
| 0-500mA  | 0-500mA              | (01*)-01AA-KMKM-B* |
| 0-1A0-1A | (01*)-01AA-LALA-B*   |                    |
| 0-2A0-2A | (01*)-01AA-LELE-B*   |                    |
| 0-5A0-5A | (01*)-01AA-LSLS-B*   |                    |
| 0-10A    | 0-10A                | (01*)-01AA-MTMT-B* |
| 0-50mV   | To suit              | (01*)-01AA-EC**-B* |

**Product Codes - Milliammeters Suppressed Zero (Accuracy ±2% ES)**

|        |                      |                       |
|--------|----------------------|-----------------------|
| 4-20mA | To suit requirements | (01*)-01RA-HG**-B*    |
|        |                      | **Specify scale value |

**Product Codes - DC Voltmeters Sensitivity 1000Ω/Volt (Accuracy ±2% ES)**

|        |        |                    |
|--------|--------|--------------------|
| 0-15V  | 0-15V  | (01*)-01VA-NDND-B* |
| 0-30V  | 0-30V  | (01*)-01VA-NLNL-B* |
| 0-50V  | 0-50V  | (01*)-01VA-NTNT-B* |
| 0-150V | 0-150V | (01*)-01VA-PZPZ-B* |
| 0-300V | 0-300V | (01*)-01VA-RXRX-B* |
| 0-600V | 0-600V | (01*)-01VA-SJSJ-B* |

**Product Codes - Frequency Meters 120V, Self Contained**

|      |         |                       |
|------|---------|-----------------------|
| 50Hz | 45-55Hz | (01*)-41SA-PNAG-AG-B* |
| 55Hz | 45-65Hz | (01*)-41SA-PNAJ-AJ-B* |
| 60Hz | 55-65Hz | (01*)-41SA-PNAN-AN-B* |

**Product Codes - Elapsed Time Meters 9999.99 hours, non-resettable**

|                |   |                       |
|----------------|---|-----------------------|
| 110/130V, 50Hz | - | (01*)-155A-PNZH-C5-B* |
| 200/250V, 50Hz | - | (01*)-155A-RNZH-C5-B* |
| 480V, 50Hz     | - | (01*)-155A-SEZH-C5-B* |
| 110/130V, 60Hz | - | (01*)-156A-PNZH-C6-B* |
| 200/250V, 60Hz | - | (01*)-156A-RNZH-C6-B* |
| 480V, 60Hz     | - | (01*)-156A-SEZH-C6-B* |

To denote the required case size, replace the 01\* in the catalogue number with 012, 013 or 014 for 2½", 3½" or 4½" respectively.

To denote the required stud fixing configuration, replace B\* with B2 (2 stud), B3 (3 stud) or B4 (4 stud).



AC Voltmeter



Frequency Meter